

Carico Statico Massimo / Max Static Load Standard Config.	=	640 kg
Carico Statico Massimo / Max Static Load Supporto esterno / External bearing (<i>Optional</i>)	=	800 kg
Gamma Potenze 50 Hz 4 poli Range Power	=	1,1 kW
Gamma Potenze 60 Hz 6 poli Range Power	=	1,1 kW
Standard Voltage (Custom voltages available on request)	=	230/400V
Rapporto di Riduzione / Ratio	=	1/56
Peso Argano / Gear Weight	=	30 kg
Peso Argano Max. / Max. Gear Weight	=	46 kg
Capacità Olio / Oil Capability	=	0,6 l
Elettromagnete freno alimentato dal motore Vac 220-230-240	Electromagnetic brake powered by motor Vac 220-230-240	
Argano Dx o Sx (visto dal motore)	Gear Box RH o LH (seen from motor)	
Argano in foto Sx	Gear on pictures LH	

**ARGANO
GEAR BOX
ELE 085**

**DIMENSIONI
DIMENSIONS**

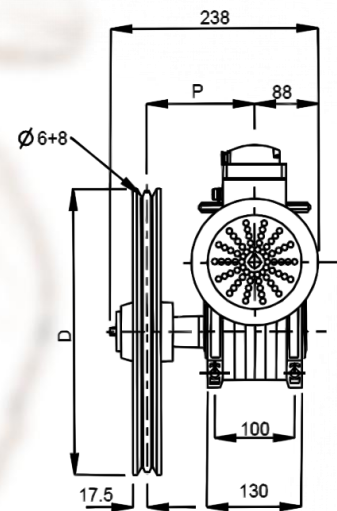
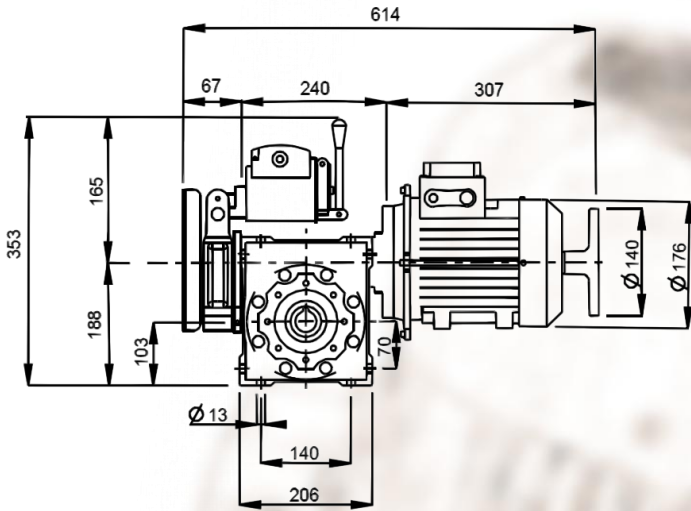

Sistema Avvolgimento Roping System	Puleggia di Trazione Traction Sheave		Dimensione Dimens. P(mm)
	D(mm)	Ø funi	
CSW	260	6-8	106
	320		
	360		

Tamburo Drum	Gole Grooves	Funi ropes	Dimensioni Dimensions		
			X(mm)	Y(mm)	Z(mm)
210	1	17	244	211	421
	2	7			
260	1	18.5	222	200	399
	2	8			

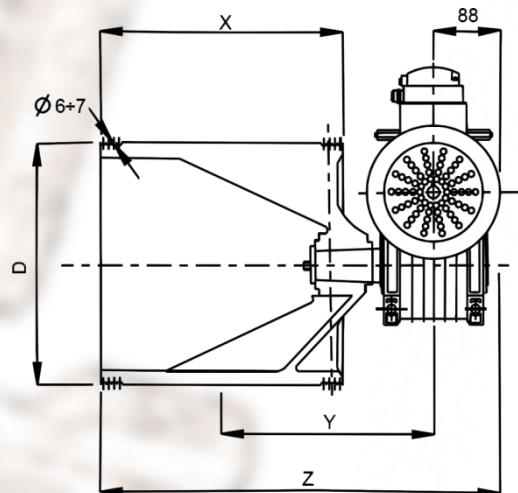

CSW: Sistema di avvolgimento convenzionale

CSW: Conventional single wrap

**MOTORI
MOTORS**

Motori Motors	Versioni disponibili Available versions	Corrente nominale Rated current	Corrente avviamento Starting current
1,1kW 1500rpm 4poli 50Hz	Trifase Threephase	2,8 A	12,9 A
	*Monofase Singlephase	9,5 A	29,5 A
1,1kW 1200rpm 6poli 60Hz	Trifase Threephase	3,6 A	9,8 A

***OPTIONAL**

OPTIONALS

Optional e accessori:	Optional and accessories:
- Versione monofase	- Monophase version
- Dispositivo antiscarrucolamento	- Ropes protection
- Elettromagnete freno 48 Vdc	- Electromagnet of brake 48 Vdc
- Supporto esterno per puleggia	- Sheave external bearing

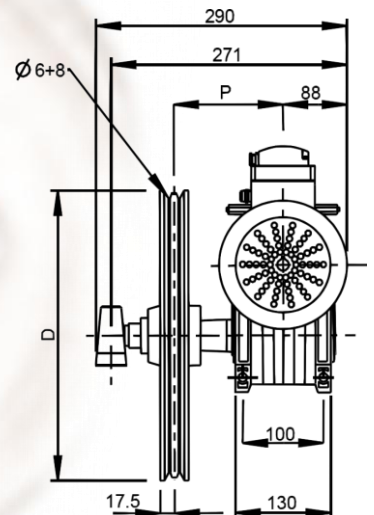

**TABELLE PORTATE
DUTY TABLE**
AC1 1500 rpm 4 Poli 50 Hz
**Sospensione 1:1
Roping 1:1**

Standard

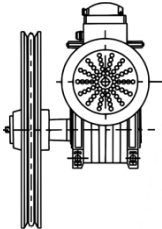
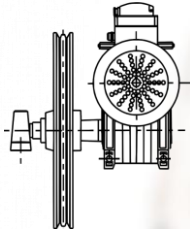
Supporto esterno
External bearing

Rapporto Riduzione Ratio	Carico Statico Static Load		Diametro Puleggia Diameter Pulley	Velocità Sincrona Speed Synchronous	Portata Rated Load
	Standard	Supporto est. Ext. bearing (Optional)			
i	kg	kg	mm	m/s	kg
1/56	640	800	260 320 360	0,34 0,43 0,49	295 230 200

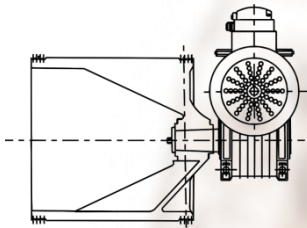

Rapporto Riduzione Ratio	Diametro Tamburo Diameter Drum	Velocità Sincrona Speed Synchronous	Configurazione funi Rope configuration	
			1 Tiro Roping Kg	2 conv. / div. Tiro Roping Kg
i	mm	m/s		
1/56	210 260	0,29 0,36	120 130	185 195

AC1 1200 rpm 6 Poli 60 Hz
**Sospensione 1:1
Roping 1:1**

Standard

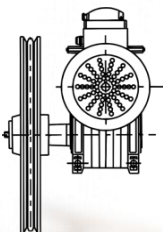
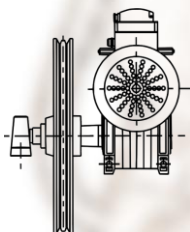
Supporto esterno
External bearing

Rapporto Riduzione Ratio	Carico Statico Static Load		Diametro Puleggia Diameter Pulley	Velocità Sincrona Speed Synchronous	Portata Rated Load
	Standard	Supporto est. Ext. bearing (Optional)			
i	kg	kg	mm	m/s	kg
1/56	640	800	260 320 360	0,27 0,35 0,39	345 265 235

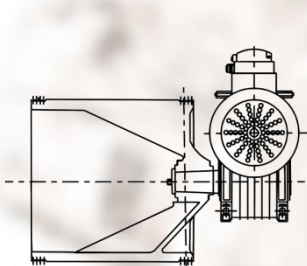

Rapporto Riduzione Ratio	Diametro Tamburo Diameter Drum	Velocità Sincrona Speed Synchronous	Configurazione funi Rope configuration	
			1 Tiro Roping Kg	2 conv. / div. Tiro Roping Kg
i	mm	m/s		
1/56	210 260	0,24 0,29	120 130	185 195

Le portate non comprendono il peso delle funi
Portata netta (versioni con puleggia): sottrarre il peso delle funi dalle portate
Portata Tiro massimo: peso cabina+portata+peso funi
- Posizione Argano = Alto
- Rendimento impianto = 0,80
- Contrappeso (versioni con puleggia) = 50%

Listed loads don't include the rope's weight
Net loads (pulley versions): subtract rope's weight from the listed loads
Roping: cabin weight+rated load+ropes weight
- Position of the Gear Box = Up
- Plant efficiency = 0,80
- Counterweight (pulley versions) = 50%

The logo features the word "ELE" in blue and "FORCE" in orange, with a stylized orange and black lightning bolt symbol between them.

Eleforce s.r.l.
Via per Panzano, 177
41013 Castelfranco Emilia (MO) – ITALY
Phone. +39 059 9537511
Fax. +39 059 921921
e-mail: info@eleforce.it
www.eleforce.it

